



**4746 N. Racine Ave
Chicago, IL 60640
Main Line: (773) 275-6800**

Technical Specifications

PARKING:

Buses will park on north side of the 1200 block of W. Lawrence Ave.

One 53' truck can park on the south side of the 1200 block of W.

Lawrence Ave.

Truck should have nose at the alley and tail by the roll-up door, 4' off curb to allow case storage.

We **DO NOT** have shore power.

You can run your generator.

Detailed map provided during advance.

LOAD IN:

Loading / Unloading

House has a truck ramp.

Ramp to street, small ramp to sidewalk, 3' push to load in door and directly on to stage.

FOH and LX push down the east gangway to side door.

Merch will push down west alley to side door.

Roll-up/ Load-in door is off of Lawrence Ave (7'10" wide x 8'2" high)

Stage Dimensions:

Stage: 40' wide x 28' deep

Stage left wing: 17' wide x 28' deep

Stage right wing: 9' wide x 28' deep

Proscenium to DS edge: 2'

Proscenium opening: 42'

Proscenium height: 25'

Stage Rigging:

Grid Height: 58'

Beam to Beam: 12' to 16'

Beam to Ceiling: 16'

Points off center (L/R): 8", 6.5', 8', 19.5'

Fly system:

Stage right – 8 working lines

300lb weight limit including cabling

House black backdrop:

Furthest US batten

Legs: MSL, MSR, DSL, & DSR

POWER:

400A 3phase DSR

200A 3phase DSR

200A 3phase DSR

MIX POSITION:

Sound and lights 20' x 10' – barricaded – front of 3rd tier

60' from FOH to front of stage

BARRICADE:

Freestanding Mojo style blow through barricade across front of DS edge

HOUSELIGHTS:

Floor – Flood lights

Balcony – Flood lights and chandeliers

Stage Manager controls from DSR

SPOTLIGHTS:

2x Ultra Arch Long Throws

Top/center of balcony

Communication headsets

BACKSTAGE:

Rooms available to tour are as follows:

Dressing room #1:

11'x17'

2x 8' couches, 1x 6' couch, coffee table, small fridge, and long table for hosp
1 out of tune piano

Dressing room #2:

11'x14'

water closet 5'x10' 1 urinal, 1 stall, 1 sink
1x 6' couch, 2 small fridges and a long table for hosp
lockable connecting door to Dressing room #3

Dressing room #3:

11'x 14'

1x 8' couch, 1x 6' couch, coffee table, small fridge
lockable connecting door to Dressing room #2

1 Production Office (Internet Hardline available)

10.5' x 7.5'

3 tables and 3 chairs

Restrooms backstage:

1 shower room

2 Bathrooms

1 Water Closet in main dressing room

Laundry Room:

1 washer/ 2 dryers onsite

All laundry must be complete before headliner hits the stage.

No candles, open flames (of any kind) and no space heaters are allowed backstage.

**These are all the rooms available to the tour.
There are NO "Extra Rooms"**

BACKSTAGE RIVIERA THEATRE

*ROOMS AVAILABLE TO TOURING PARTY

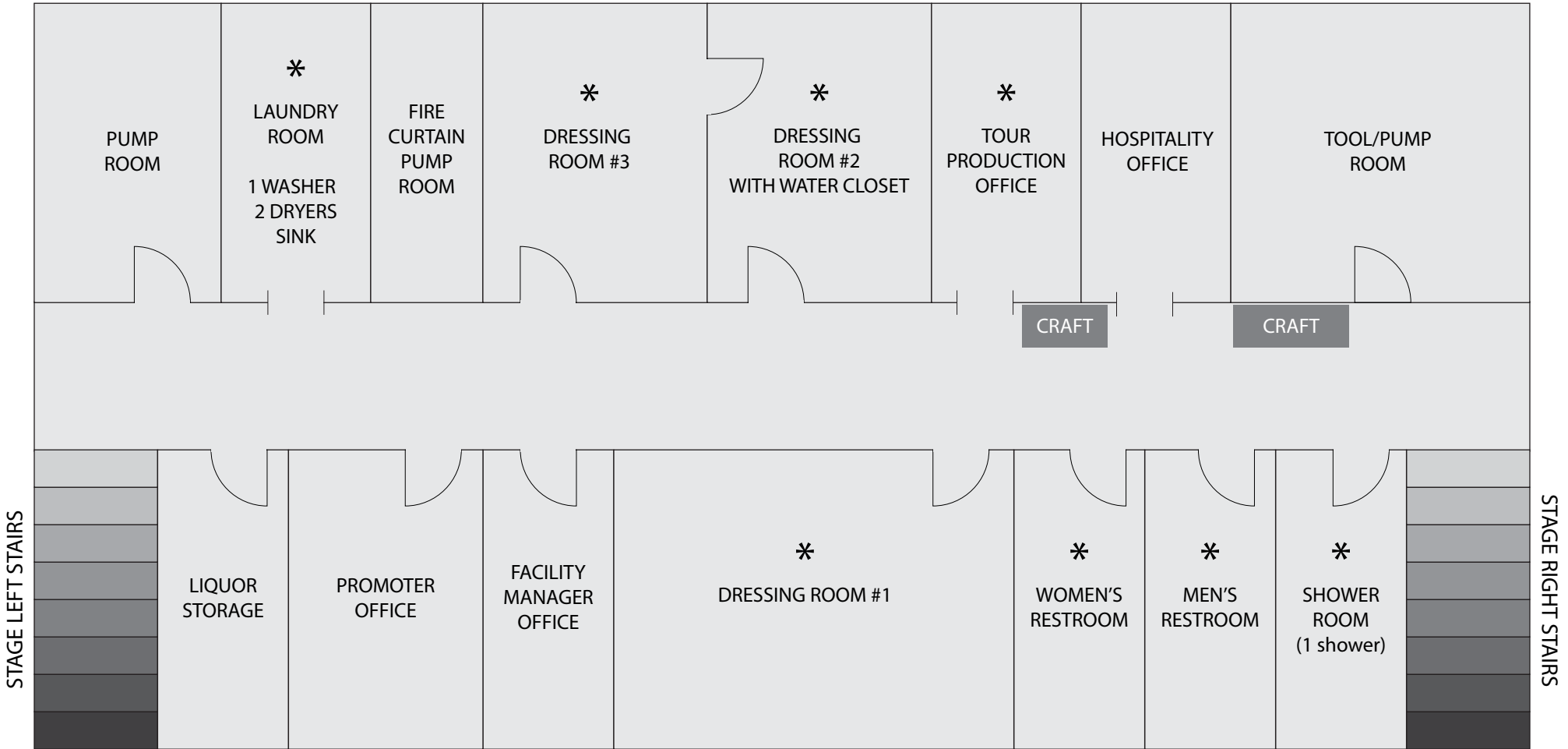

Description	Qty	Location	Notes
PA System			
(2) L-Acoustics L2 over (1) L2D enclosure array	2	Mains Left & Right	
L-Acoustics KS28 subwoofer	12	Downstage Edge	
L-Acoustics A10 Focus	4	Front Fills	
L-Acoustics A10i WIDE	5	Distributed Fills	installation version
L-Acoustics A15i WIDE	4	Distributed Fills	installation version
L-Acoustics P1 Digital Audio Processor	2	FOH	Redundant AVB network
L-Acoustics LA7.16 16-channel amplified controller	7		Mains LR & Distributed Delays
L-Acoustics LA12X 4-channel amplified controller	6		Subs & FF

Sidfill Monitor System

(2) L-Acoustics KS21 / (1) A15 FOCUS / (1) A15 WIDE	2	Flown SL & SR	
---	---	---------------	--

Stage Monitors

L-Acoustics X15 HiQ	12		Stage Wedges
L-Acoustics KS21 subwoofer	2		

FOH Audio Console Package

DiGiCo Quantum 225 w/ Overview Screen	1		
XTA M36 Console Switcher	1		Analog, AES, and Dante
Mackie SRM150	1		Shout
ClearCom RS-701 Single-Channel Beltpack			
ClearCom HS-6 Telephone style intercom handset	1		
Pro Intercom Blazon 3 strobe light & switchable sonic alert	1		
Middle Atlantic UPS 2200R-IP	1		

Monitors Console Package - SL

DiGiCo Quantum 225 w/ Overview Screen	1		
Mackie SRM150	1		Shout
ClearCom RS-701 Single-Channel Beltpack	1		
ClearCom HS-6 Telephone style intercom handset	1		
Pro Intercom Blazon 3 strobe light & switchable sonic alert	1		
Middle Atlantic UPS 2200R-IP	1		

Stage Patch & Monitors Peripherals

48x10 Analog XLR Splitter w/ 1 Direct & 2 ISO W4 Outs	1		
DiGiCo SD Rack 56x56*	2		All 32-bit Analog Cards for In & Out
Whirlwind Patchmaster60 (5) mounted W1-XLR(M) fanouts	1		
Whirlwind W1 12-channel subsnake (25')	2		
Whirlwind W1 12-channel subsnake (50')	2		
Whirlwind W1 12-channel subsnake (75')	4		
Whirlwind W1 12-channel subsnake (100')	2		
Whirlwind W1 Stage Box (colored)	5		
Whirlwind W1 to (12) XLR(F) Fan-In	2		
Whirlwind W1 to (12) XLR(M) Fan-Out	1		
12-channel XLR Fan-tp-Fan (25')	2		

Power

EMG 200A 12RU Camlok In/Thru AC Distro w/ L21-30 & Edison	1		
L21-30 & Edison Stingers/Boxes for Stage Power			

Description	Qty	Location	Notes
Microphones & Dis			
Shure SM57-LC	8		
Shure Beta 57A	4		
Shure Beta 91A	2		
Shure Beta 52A	2		
Shure KSM32-CG	2		
Sennheiser e904	6		
Sennheiser e906	4		
Sennheiser e914	6		
Sennheiser e935	8		
Sennheiser XS1	4		
Sennheiser MKH-416			
Radial JDI	8		
Radial JDI Stereo	4		
Radial JDI Duplex	2		
Radial J48	8		

Stands & Clamps			
K&M 25950 Super Short Boom Stand	2		
Atlas MS20 Boom Stand	8		
PB21XEB	8		
K&M 259 Short Boom Stand	10		
K&M 201 a/2 Tall Boom Stand	15		
LP Claw	6		
Audix Cab Grabbers	2		

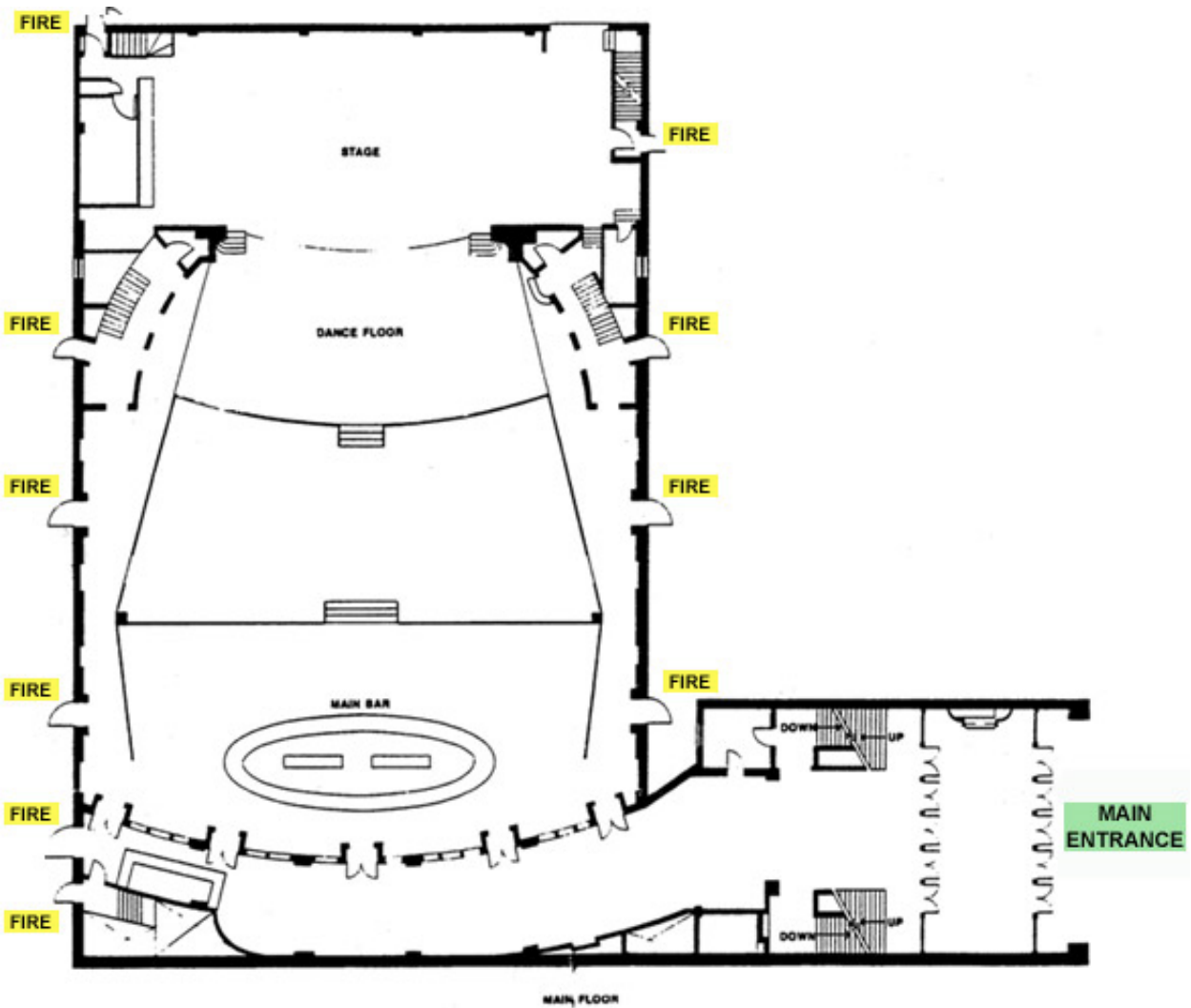

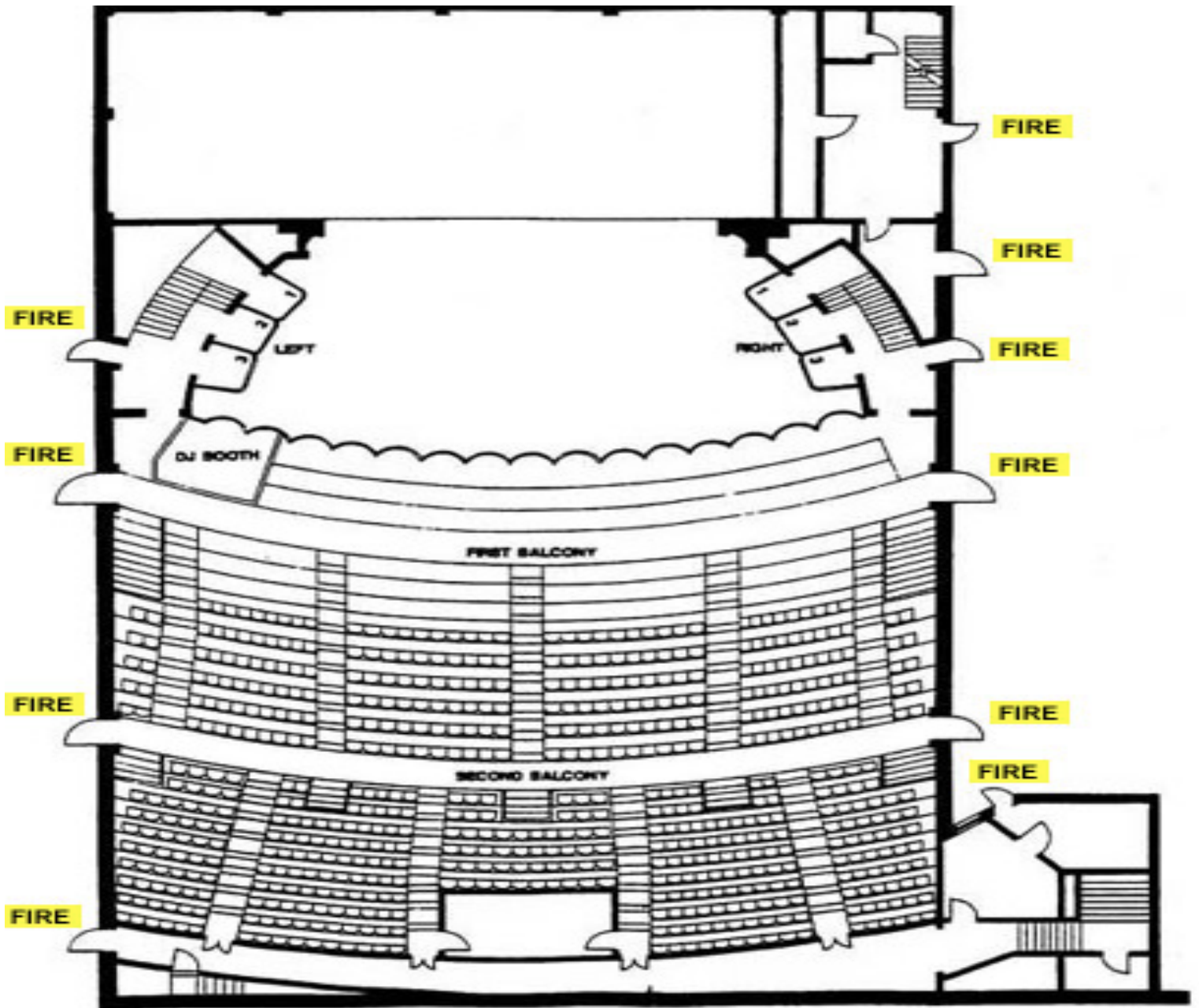

UPPER LEVEL SECOND AND THIRD FLOOR

Disclaimer
This drawing is a representation of concepts only and it is intended to be used as a guide of the approximate room layout. Whereas actual on-site variations of adjustments may occur, LMG cannot be held responsible for submitting this as an exact plan. All plans must comply with local safety and fire codes and be approved and/or certified by a qualified source as determined by the facility and/or local regulations. LMG takes no responsibility to certify any of the included concepts in this plan. All contents of this drawing and design plans, ideas, and concepts indicated within are property of LMG and cannot be reproduced, redrawn, or disclosed to any individual, firm, or company without the express written consent of LMG. Copyright 2016

NO	DATE	BY	REVISION NOTES

NO	DATE	BY	ISSUE NOTES

Riviera Theatre

REGGING NOTES:

AUDIO NOTES:

VIDEO NOTES:

SHOW NAME: Various
SHOW DATE:
PRODUCER:
ACCOUNT EXECUTIVE:

VENUE: Riviera Theater CHICAGO
ROOM: ROOM
ADDRESS: 4746 N. Racine Ave Chicago, IL 60640
DRAWN BY: BOZ
PROJECT: RIVIERA THEATER
SCALE: 7/16" = 1'-0" SHEET # 1 OF 1
DRAWING TITLE: Plan View

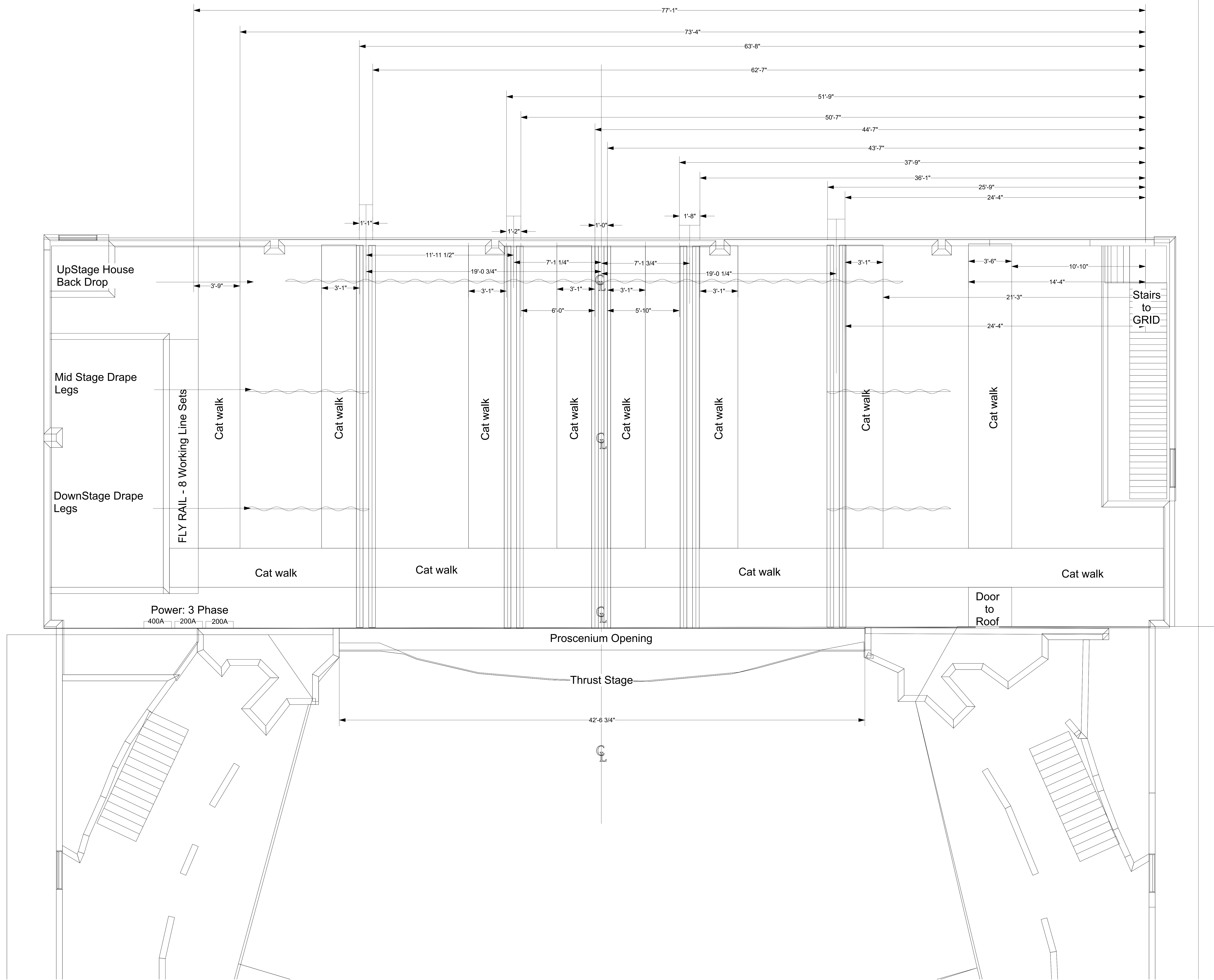





Project House Lighting Package	
Project location Riviera Theatre	
Project date 2024	
Drawing author Hubbell	Drawing version v1.0

Lighting designer
Performance Lighting, Inc.

Phone
847-952-9600

Email
info@performancelightinginc.com

Symbol key

-  Impression X4 (14)
-  Fuze Max Spot (12)
-  CUEPIX Blinder WW2 (8)
-  Jolt Panel FX (8)
-  Stingray IP65 RGBW (6)

This preliminary design concept is only to be used for illustrative purposes!

Riv Show Files





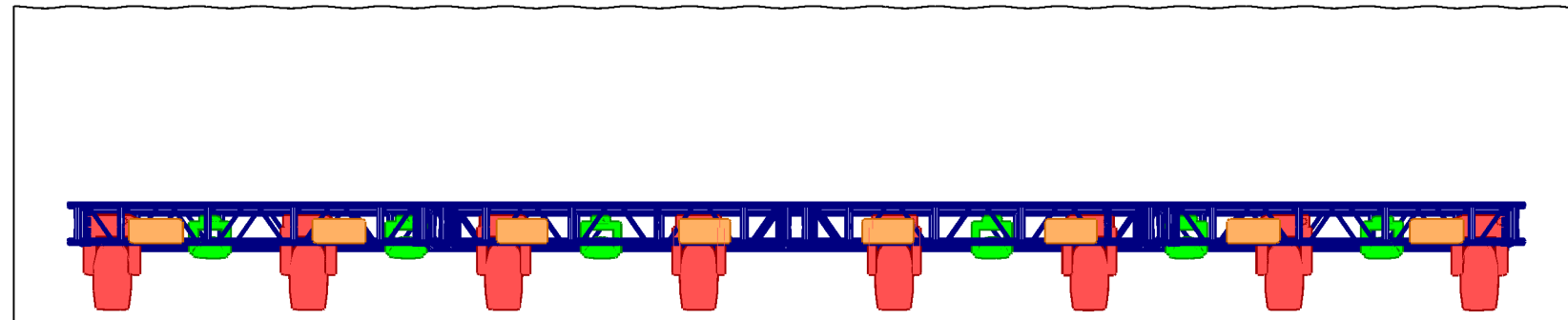
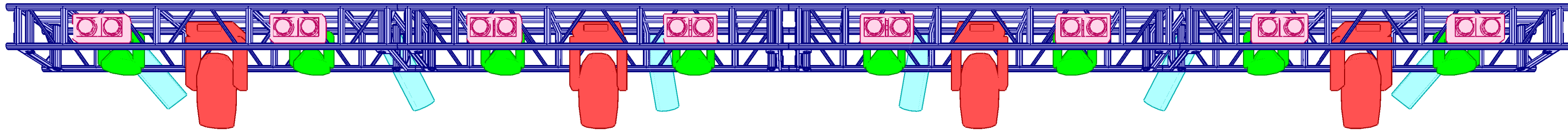

Riviera Theatre
House Lighting Package
2024 Riviera Theatre





Project		House Lighting Package
Project location		Riviera Theatre
Project date		2024
Drawing author	Drawing version	
Hubbell	v1.0	
Lighting designer		
Performance Lighting, Inc.		
Phone		
847-952-9600		
Email		
info@performancelightinginc.com		

Symbol key

-  Impression X4 (14)
-  Fuze Max Spot (12)
-  CUEPIX Blinder WW2 (8)
-  Jolt Panel FX (8)
-  Stingray IP65 RGBW (6)

This preliminary design concept is only to be used for illustrative purposes!

Riv Show Files

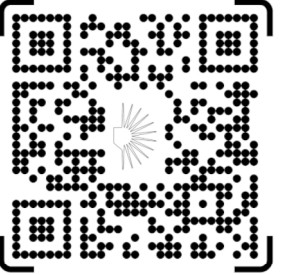

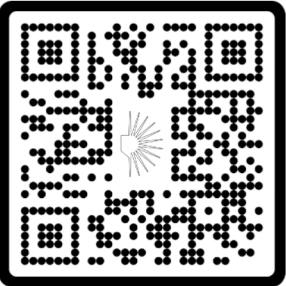

Request Swag Here!

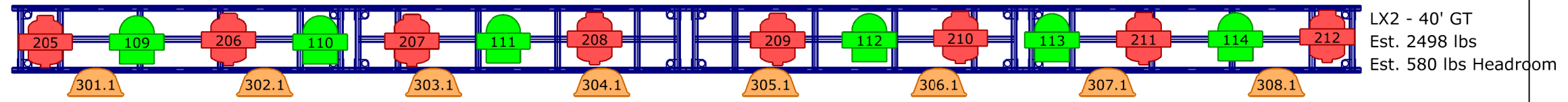

Layer	Fix ID	Patch	Name	Fixture Type	Layer	Fix ID	Patch	Name	Fixture Type
WASH	101	1.001	DS WASH	3 Impression X4 High Res (3)	SPOT	211	3.132	US SPOT 7	7 Fuze max Spot Standard (7)
WASH	102	1.022	DS WASH	3 Impression X4 High Res (3)	SPOT	212	3.166	US SPOT 8	7 Fuze max Spot Standard (7)
WASH	103	1.043	DS WASH	3 Impression X4 High Res (3)	STROBE	301.1	2.2	US JOLT 1	6 Jolt Panel 51 Ch (6)
WASH	104	1.064	DS WASH	3 Impression X4 High Res (3)	STROBE	302.1	2.251	US JOLT 2	6 Jolt Panel 51 Ch (6)
WASH	105	1.085	DS WASH	3 Impression X4 High Res (3)	STROBE	303.1	2.302	US JOLT 3	6 Jolt Panel 51 Ch (6)
WASH	106	1.106	DS WASH	3 Impression X4 High Res (3)	STROBE	304.1	2.353	US JOLT 4	6 Jolt Panel 51 Ch (6)
WASH	107	1.127	DS WASH	3 Impression X4 High Res (3)	STROBE	305.1	3.2	US JOLT 5	6 Jolt Panel 51 Ch (6)
WASH	108	1.148	DS WASH	3 Impression X4 High Res (3)	STROBE	306.1	3.251	US JOLT 6	6 Jolt Panel 51 Ch (6)
WASH	109	2.001	US WASH	3 Impression X4 High Res (3)	STROBE	307.1	3.302	US JOLT 7	6 Jolt Panel 51 Ch (6)
WASH	110	2.022	US WASH	3 Impression X4 High Res (3)	STROBE	308.1	3.353	US JOLT 8	6 Jolt Panel 51 Ch (6)
WASH	111	2.043	US WASH	3 Impression X4 High Res (3)	BLINDER	401	1.305	DS MOLE 1	4 CuePix Blinder WW2 2 channel (4)
WASH	112	3.001	US WASH	3 Impression X4 High Res (3)	BLINDER	402	1.307	DS MOLE 2	4 CuePix Blinder WW2 2 channel (4)
WASH	113	3.022	US WASH	3 Impression X4 High Res (3)	BLINDER	403	1.309	DS MOLE 3	4 CuePix Blinder WW2 2 channel (4)
WASH	114	3.043	US WASH	3 Impression X4 High Res (3)	BLINDER	404	1.311	DS MOLE 4	4 CuePix Blinder WW2 2 channel (4)
SPOT	201	1.169	DS SPOT 1	7 Fuze max Spot Standard (7)	BLINDER	405	1.313	DS MOLE 5	4 CuePix Blinder WW2 2 channel (4)
SPOT	202	1.203	DS SPOT 2	7 Fuze max Spot Standard (7)	BLINDER	406	1.315	DS MOLE 6	4 CuePix Blinder WW2 2 channel (4)
SPOT	203	1.237	DS SPOT 3	7 Fuze max Spot Standard (7)	BLINDER	407	1.317	DS MOLE 7	4 CuePix Blinder WW2 2 channel (4)
SPOT	204	1.271	DS SPOT 4	7 Fuze max Spot Standard (7)	BLINDER	408	1.319	DS MOLE 8	4 CuePix Blinder WW2 2 channel (4)
SPOT	205	2.064	US SPOT 1	7 Fuze max Spot Standard (7)	LEKO	501	1.321	Str RL 4.1	8 Stingray RGBL 4 channel (8)
SPOT	206	2.098	US SPOT 2	7 Fuze max Spot Standard (7)	LEKO	502	1.325	Str RL 4.2	8 Stingray RGBL 4 channel (8)
SPOT	207	2.132	US SPOT 3	7 Fuze max Spot Standard (7)	LEKO	503	1.329	Str RL 4.3	8 Stingray RGBL 4 channel (8)
SPOT	208	2.166	US SPOT 4	7 Fuze max Spot Standard (7)	LEKO	504	1.333	Str RL 4.4	8 Stingray RGBL 4 channel (8)
SPOT	209	3.064	US SPOT 5	7 Fuze max Spot Standard (7)	LEKO	505	1.337	Str RL 4.5	8 Stingray RGBL 4 channel (8)
SPOT	210	3.098	US SPOT 6	7 Fuze max Spot Standard (7)	LEKO	506	1.341	Str RL 4.6	8 Stingray RGBL 4 channel (8)

200A & 400A 3PH Services Stage Right
Flow Thru Available

DMX via XLR5 Default
Artnet Available
Cat 6 Available
MA2L @ FOH

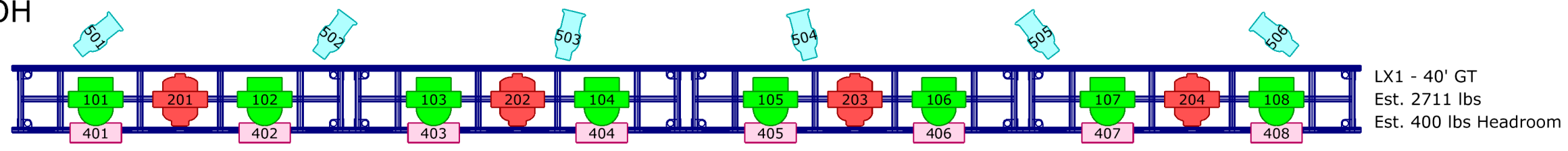

Project		House Lighting Package
Project location		Riviera Theatre
Project date		2024
Drawing author	Drawing version	
Hubbell	v1.0	
Lighting designer		Performance Lighting, Inc.
Phone		847-952-9600
Email		info@performancelightinginc.com

Symbol key

- Impression X4 (14)
- Fuze Max Spot (12)
- CUEPIX Blinder WW2 (8)
- Jolt Panel FX (8)
- Stingray IP65 RGBW (6)

This preliminary design concept is only to be used for illustrative purposes!

Riv Show Files

